



151 W. Church Street
Lewisville, TX 75057

A G E N D A

OLD TOWN DESIGN REVIEW COMMITTEE MONDAY, JUNE 10, 2024

LEWISVILLE CITY HALL
DEVELOPMENT SERVICES CONFERENCE ROOM
2ND FLOOR
151 WEST CHURCH STREET
LEWISVILLE, TEXAS

REGULAR SESSION MEETING – 4:00 P.M.

-
1. **Call to Order and Announce That a Quorum is Present.**
 2. **Approve the Minutes from the May 13, 2024 Meeting.**
 3. **Consideration of a Letter of Design Approval for an Exterior Modification Consisting of Window Replacement for one Townhome Unit Located at 144 Leonard Street; as Requested by Carolyn Goodwin, Zip Permits, on Behalf of the Property Owner, Debra Freeman. (24-04-16-LDA)**
 4. **Consideration of a Letter of Design Approval for an Exterior Modification Consisting of Window Replacement for one Townhome Unit Located at 421 Legends Drive; as Requested by Carolyn Goodwin, Zip Permits, on Behalf of the Property Owners, Brian Potter and Christina Bocelli. (24-03-10-LDA)**
 5. **Announcements**
 6. **Adjournment**

I do hereby certify that the above notice of meeting of the City of Lewisville Old Town Design Review Committee was posted at City Hall, City of Lewisville, Texas in compliance with Chapter 551, Texas Government Code on _____, 2024 by _____ A.M.

Planning Department

NOTICE OF ASSISTANCE AT THE PUBLIC MEETINGS

The Lewisville City Hall & Development Services Conference Room are wheelchair accessible. Access to the building and special parking are available at the front entrance along Church Street. Persons with disabilities who plan to attend this meeting and who may need auxiliary aids or services such as interpreters for persons who are deaf or hearing impaired, readers, or large print, are requested to contact the Planning Department at (972) 219-3455 or by FAX (972) 219-3698 at least two (2) working days prior to the meeting so that appropriate arrangements can be made.

**MINUTES
OLD TOWN DESIGN REVIEW COMMITTEE
MAY 13, 2024**

Committee Members Present: Vice-Chair Amy Puckett, Audra Smolinski, Kelly Blackall,

Committee Members Absent: Chair Randy Tetzlaff, Odin Clack

City Staff Present: Michele Berry, Planning Manager; Lauren Cook, Planner I.

Item 1: Call to Order and Announce That a Quorum is Present

With a quorum present, the Old Town Design Review Committee meeting was called to order by Vice-Chair Amy Puckett at 4:00 p.m. on Monday, May 13, 2024, in the Development Services Conference Room, 2nd Floor, of the Lewisville City Hall, 151 West Church Street, Lewisville, Texas.

Item 2: Approve the Minutes From the April 22, 2024 Meeting

The first item on the agenda was the approval of the minutes from the April 22, 2024 Meeting. *A motion was made by Audra Smolinski and seconded by Kelly Blackall to approve the minutes as presented. The motion passed unanimously (3-0).*

Item 3:

Consideration of a Letter of Design Approval for a Single Tenant Wall Sign; Located at 115 West Main Street; as Requested by Kenneth Waits, the Applicant, on Behalf of Lauren Miller, the Business Owner and RO Properties, the Property Owner. (24-04-17-LDA)

Lauren Cook, Planner I, gave a brief overview of the proposed single tenant wall sign with a recommendation to approve the sign with modifications to allow the sign to go above its height. There was no discussion. *A motion was made by Kelly Blackall and seconded by Audra Smolinski to approve the sign with modifications requested. The motion passed unanimously (3-0).*

Item 4: Announcements

There were no announcements.

Item 5: Adjournment

There being no other items to discuss, the meeting was adjourned at 4:03 p.m.

Page 2
Minutes - Old Town Design Review Committee
May 13, 2024

These minutes approved by the Old Town Design Review Committee on June 10, 2024.

Respectfully submitted,

Approved,

Michele Berry, Planning Manager

Randy Tetzlaff, Chair

STAFF REPORT

TO: Old Town Design Review Committee

FROM: Grace Martin-Young, Planner I

MEETING

DATE: June 10, 2024

SUBJECT: Consideration of a Letter of Design Approval for an Exterior Modification Consisting of Window Replacement for one Townhome Unit Located at 144 Leonard Street; as Requested by Carolyn Goodwin, Zip Permits, on Behalf of the Property Owner, Debra Freeman. (24-04-16-LDA)

BACKGROUND

Zip Permits, a third-party permitting company, has requested a Letter of Design Approval to replace four (4) windows on a two-story townhome unit within the Main Street Village Development.

ANALYSIS

The proposed windows are double hung with vinyl frames and have a visible light transmittance level of 0.48, a solar heat gain coefficient of 0.21, and U-factor of 0.28 U.S./I.P. The proposed windows are the same style, material, and visible light transmission level as the existing windows.

RECOMMENDATION

Staff recommends that the Old Town Design Review Committee approve the Letter of Design Approval.

144 LEONARD ST

1 message

CAROLYN GOODWIN <zip.permits@yahoo.com>
To: Grace Martin-Young <gmartin-young@cityoflewisville.com>

Thu, Jun 6, 2024 at 9:05 PM

Discription of work:

Replace 4 windows - same size, color and style
color - white
no grids
ufactor= .28
shgc = 021
Product Brochure attached

Contractor: Window World

Attached is the drawing and energy sticker

google earth arel view: current windows are whiteand double hung as well andas you are looking at picture it is on the right of the building

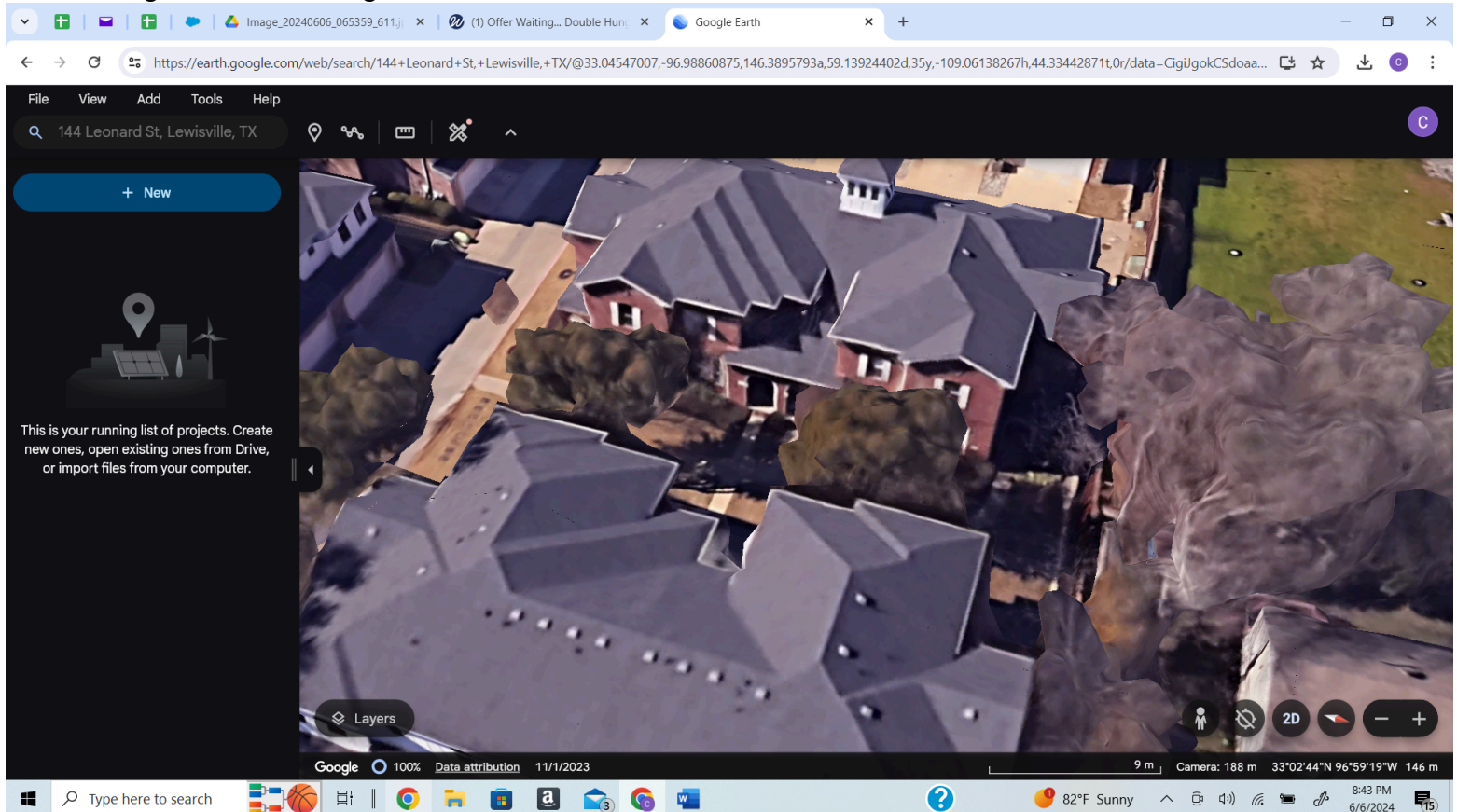

Carolyn Goodwin

Owner
Zip Permits

Mobile: 972-670-6690

Email: zip.permits@yahoo.com



WW Product Brochure.pdf

693K

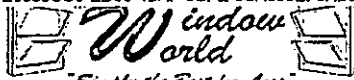

1.866.WIND.188 (866-946-3189)

Window and Patio Door Contract

Locations:
Fort Worth, 2570 N Great SW Pkwy Ste 100, Grand Prairie, TX 75040
Dallas: 800 N. Cox Rd. Ste 2052, Richardson, TX 75080

Name: **DEBRA FREEMAN** Email: **debra.freeman@windowworld.com** Complete Job? **Y (N)** Remaining # of Windows? **5**
 Address: **144 LEONARD ST** Customer ID # **47740** Primary # **214 417 7312** Secondary #
 City: **LEWISVILLE** State: **TX** Zip Code: **75057** Other #

Windows				Options		AMT	TOTAL	
QTY	Double Hung	Series	Model #	AMT	TOTAL			
4	4000 DH Fusion Weld	3001	3001	\$455	1820			
	4000 DH Foam Enhanced	3001-FE		\$480				
	<i>(Standard Residential Windows)</i>							
	Other Styles							
	Picture Window	3004		\$519				
	2 Lite Slider	3002		\$519				
	3 Lite Slider	3003		\$680				
	Casement / Awning			\$599				
	Double Casement			\$1,088				
	Foam-Enhanced Upcharge - Add			\$25				
	Special Shape W/ Operating Sash			\$719				
	Over 120 Ul Large Window- Add			\$100				
	Specialty Windows							

QTY	Options	AMT	TOTAL
<input checked="" type="checkbox"/>	Extruded Aluminum Half Screen	Incl	
<input checked="" type="checkbox"/>	Extruded Aluminum Full Screen	\$22	
<input checked="" type="checkbox"/>	Double Locks (> 29" wide)	Incl	
<input checked="" type="checkbox"/>	Argon Gas	\$21	<i>incl</i>
<input checked="" type="checkbox"/>	Krypton Gas	\$119	
<input checked="" type="checkbox"/>	Foam Insulation Wrap	\$15	<i>incl</i>
<input type="checkbox"/>	Beige / Clay Color	\$52	
<input type="checkbox"/>	Woodgrain - Inside Surface	\$90	
<input type="checkbox"/>	Tempered Glass Sq Ft	\$7/Sq ft	
<input type="checkbox"/>	Obscure Glass (Rain / Sid)	\$30	
<input checked="" type="checkbox"/>	Lifetime Glass Break Warranty	\$39	<i>incl</i>
<input type="checkbox"/>	Nail Fin	\$10	
<input type="checkbox"/>	Onal/Colloge Style 60/40	\$36	
<input type="checkbox"/>	Flat / Contoured Grids	\$45	<i>incl</i>
<input type="checkbox"/>	Exterior Color (Exterior Surface Only)	\$225	

Specialty Window Options

QTY	Options	AMT	TOTAL
<input type="checkbox"/>	Energy Star Pkg Triple Pane Energy Star	\$29	<i>incl</i>
<input type="checkbox"/>	TK2 Plus Elite- Energy Star Most	\$394	

Additional Labor Charges

QTY	Options	AMT	TOTAL
<input type="checkbox"/>	Remove Storm Window	\$10	
<input type="checkbox"/>	Window Removal	\$60	<i>240</i>
<input type="checkbox"/>	Remove Steel Window	\$70	
<input type="checkbox"/>	Remove Aluminum in Stucco	\$90	
<input type="checkbox"/>	Remove Steel in Stucco	\$110	
<input type="checkbox"/>	Install Mullion for Multi-Unit	\$30	
<input type="checkbox"/>	Structural Mullion for Multi-Unit	\$90	
<input type="checkbox"/>	Custom Jamb/Sill Cutback	\$80	
<input type="checkbox"/>	Install Exterior Capping	\$125	
<input type="checkbox"/>	Install Vinyl Int/Ext Trim	\$40	<i>160</i>
<input type="checkbox"/>	Special Shape Trim	\$40	
<input type="checkbox"/>	Repair Sill OR Jamb	\$25 / Ft	
<input type="checkbox"/>	2nd Story Charge	\$10	<i>40</i>
<input type="checkbox"/>	Bay Window Finish & Trim	\$100	
<input type="checkbox"/>	Header Flashing	\$12	<i>48</i>
<input type="checkbox"/>	J-Channel	\$40	
<input type="checkbox"/>	Clear Story		
<input type="checkbox"/>	Maintenance Agreement		

ALL windows and doors INCLUDE Low-E Elite glass and meet Texas energy regulations. All prices INCLUDE basic installation.

PRE 1978 BUILT HOMES (Federal Lead Containment Law)
My home was built in the year **2006** Initial: **EF**

DOORS				AMT	TOTAL
QTY	Series	Model #	AMT	TOTAL	
	Vinyl Rolling Door 6'	6406 (2p)	\$1,659		
	Vinyl Rolling Door 8'	6408 (2p)	\$1,857		
	Vinyl Rolling Door 9'	6409 (3p)	\$2,350		
	Vinyl Rolling Door 12'	6412 (4p)	\$2,935		
	5" Rail (per panel)		\$90		
	7" Rail / French (per panel)		\$180		
	8" Height (per panel)		\$90		
	Colonial Grns (per panel)		\$60		
	Beige / Clay (per panel)		\$35		
	Vinyl Patio Door Trim		\$95		
	Integrated Mini Blinds				
	Exterior Color (Exterior Surface Only)				

Window World agrees to install windows and doors as noted above and on the attached order form and to perform other services as specified above for the price stated on this form. No other promises, expressed or implied, are made unless those expressed in writing on this agreement.

If Window World seeks legal counsel to enforce this agreement under this contract, Customer agrees to pay reasonable attorney's fees and costs.

The buyer is responsible for:
- Securing permits, unless noted on the contract.
- Removal and re-installation of any existing security system, burglar bars, AC units, window coverings, and/or obstructions prior to installation.

Additional charges for removing items are at the following rates: AC Unit \$50, Curtain \$25/Window, Furniture \$10/Item, Stairs \$50 each.

INITIALS: **EF**

NOTICE OF CANCELLATION
You the buyer may cancel this transaction at any time prior to midnight of the third business day after the date of this transaction. Notice of cancellation must be in writing postmarked no later than midnight of the following third business day.

INITIALS: **EF**

THIS IS A CUSTOM ORDER NOT FOR RESALE!
Windows that are unopened after 12 months will be deemed abandoned and will remain property of Window World.

No extra work if not in writing! **W 6 - 9**

Customer Agrees to the terms of payment as follows:

Total List Price	\$	
Administrative & Setup Fee \$ 150	\$	150.00
Permit Fee	\$	15.00
Total Amount	\$	290.01
Custom Order Deposit (50%)	\$	145.01
Balance Paid to Installer upon Completion	\$	145.00
Am't Financed	\$	

Bill Large Jones 214-24-24 Date
 Eric Freeman 5E478FCD04E8435... Date
 Window World Care\$

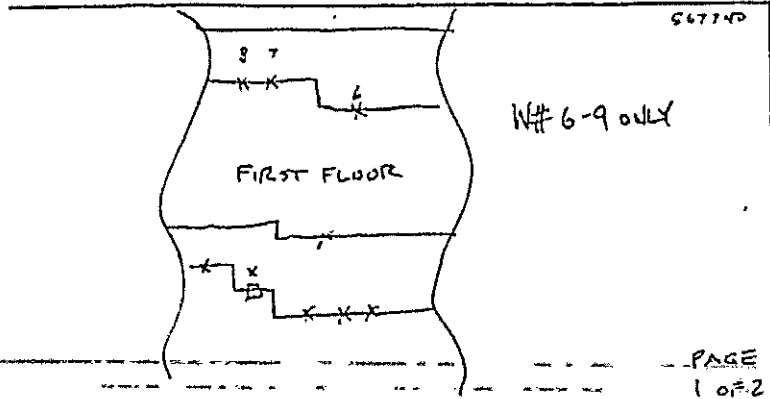

WINDOW AND PATIO DOOR ORDER FORM

PO# _____ ACCT# _____ ORDER DATE: _____

DEBRA & ERIC FREEMAN Phone: 214 417 7315
 Customer: _____ Phone: _____

144 LEONARD ST LEWISVILLE 75057
 Address City Zip

Estimator: OSD-LAYNE JONES Phone: 972 742 0149

PAGE 1 of 2

QTY	MODEL	VINYL OPTION	AT OPTION	EXT OPTION	WIDTH	HEIGHT	MOBILE WEIGHT	LED WEIGHT	CUSTOM FINISH	ADD-ON FINISH	GLASS TYPE	GLASS OPTION	FOAM NUMBER	CRD OPTICAL STYLE	CRD OPTICAL PATTERN	DRIVE PULLEY	FLIP FLAG	INSULATION	DEPTH	FLAS SCREEN	OPER DIV	HEAVY FLANK	TYPE EXT	FLOOR NUMBER	TYPE TRIM	TYPE REMOVE	TYPE INSTALL	5 LL	REMARKS
1	3001	WH			23 1/8	33 3/4				6	LEE			D1	1010								Y	WD		NL	1		
1	3001	WH			34 3/4	58 1/8				7	LEE			31	1010								Y	WD		NL	1		
1	3001	WH			35 1/4	58 1/2				8	LEE			31	1010								Y	WD		NL	1		

I certify the salesperson has explained and identified each and every abbreviation, term, and drawing on this page to my full and complete understanding including how each and every window is removed, installed, trimmed, accessorized, and warranted.

[Signature]
 DATE: 1-31-24

NOTES

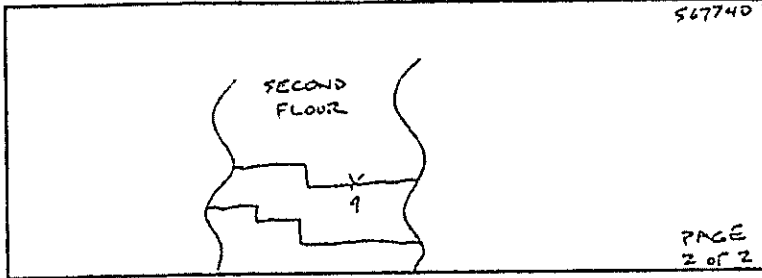

WINDOW AND PATIO DOOR ORDER FORM

PO#	ACCT #	ORDER DATE.
Customer: DEBRA & ERIC FREEMAN		Phone: 714 417 7315
Address: 144 LEONARD ST		City: LEWISVILLE
		Zip: 75057
Estimator: DSO - LAYNE JONES		Phone: 972-742-0149

QTY	MODEL	TYPE	FINISH	GLASS	UPPER	LOWER	SECTION	WINDOW	CLASS	FOAM	GRID	LINE	DISC	DISC	TEMP	WATER	WATER	FULL	DILL	NON	TYPE	TYPE	TYPE	TYPE	SEL
1	2031	WLL		35/2	59/8			9	LEE		BL	1010									132	132	0		
2																									
3																									
4																									
5																									
6																									
7																									
8																									
9																									
10																									
11																									
12																									
13																									
14																									
15																									
16																									
17																									
18																									
19																									
20																									
21																									
22																									
23																									
24																									



I certify the salesperson has explained and identified each and every abbreviation, term, and drawing on this page to my full and complete understanding including how each and every window is removed, installed, trimmed, accessorized, and warranted.

1-31-24
 OWNER DATE

NOTES:

White Copy - Original Yellow Copy - Estimator Pink Copy - Customer

PAGE 1 OF

Test Methods: AAMA/WDMA/CSA 1011.5.2/A440-03 and CSA A440S1-03	
Window Size: 28.25x45.6 PG25	251-834725 
 National Fenestration Rating Council CERTIFIED	FMI MODEL 3801 - DOUBLE HUNG CFB- PSD-FF-89-20184-20201 SER 10 VINYL - WELDED - DOUBLE GLZD 3/4" IG. DS LE70. FROSH
ENERGY PERFORMANCE RATINGS	
U-Factor 0.28 1.59 <small>(U.S./IP) (Metric/ST)</small>	Solar Heat Gain Coefficient 0.21
ADDITIONAL PERFORMANCE RATINGS	
Visible Transmittance 0.48	—
<small>Manufacturer stipulates that these ratings conform to applicable NFRC procedures for determining window product performance. NFRC ratings are determined for a fixed set of environmental conditions and a specific product size. NFRC does not recommend any product and does not warrant the suitability of any product for any specific use. Contact manufacturer's literature for other product performance information. www.nfrc.org</small>	

LOW-E ELITE (LEE)

STAFF REPORT

TO: Old Town Design Review Committee

FROM: Grace Martin-Young, Planner I

MEETING

DATE: June 10, 2024

SUBJECT: Consideration of a Letter of Design Approval for an Exterior Modification Consisting of Window Replacement for one Townhome Unit Located at 421 Legends Drive; as Requested by Carolyn Goodwin, Zip Permits, on Behalf of the Property Owners, Brian Potter and Christina Bocelli. (24-03-10-LDA)

BACKGROUND

Zip Permits, a third-party permitting company, has requested a Letter of Design Approval to replace ten (10) windows on a two-story townhome unit within the Main Street Village Development.

ANALYSIS

The proposed windows are double hung and single hung arch styles with white vinyl frames. Two of the double hung windows are being installed on the ground floor living room, with the rest on the second story. The double and single hung windows are energy star certified and have a visible light transmittance level of 0.40 and 0.48, a solar heat gain coefficient of 0.20 and 0.17, and U-factor of 0.30 and 0.28. U.S./I.P.

RECOMMENDATION

Staff recommends that the Old Town Design Review Committee approve the Letter of Design Approval.



Grace Martin-Young <gmartin-young@cityoflewisville.com>

421 Legends Dr

CAROLYN GOODWIN <zip.permits@yahoo.com>

Thu, Jun 6, 2024 at 9:05 PM

To: Grace Martin-Young <gmartin-young@cityoflewisville.com>

Scope of work:

Replace 10 windows -same size, color and style as current windows

Color: White

No grids

Ufactors: .30 (for double hungs) and .28 (for single hungs)

SHGC: .17 (for double hungs) and .20 (for single hungs)

Contractor: New South Window Solutions

drawing and specs are attached to application

Google Earth interface showing an aerial view of a residential neighborhood. The search bar at the top contains "421 Legends Drive, Lewisville, TX". A sidebar on the left features a "+ New" button and a message: "This is your running list of projects. Create new ones, open existing ones from Drive, or import files from your computer." A pop-up information box on the right displays the address "421 Legends Dr, Lewisville, TX 75057" and "22W6+34 Lewisville, Texas", along with a "Save to project" button. The main map area shows a street grid with a red location pin on "421 Legends Dr". The bottom status bar indicates a 100% zoom level, a camera height of 202 m, and a date of 11/1/2023.

Windows taskbar showing the search bar with "Type here to search" and several application icons including Chrome, File Explorer, and Amazon. The system tray on the right shows the date and time as 9:02 PM on 6/6/2024.

Browser address bar showing the URL: "https://earth.google.com/web/search/421+Legends+Drive,+Lewisville,+TX@33.0451768,-96.9896725,153.99109169a,62.36208342d,35y,-139.93566842h,47.55891291t,0.00000002r/data=Co...".

Google Earth interface showing a closer aerial view of the same residential neighborhood. The search bar at the top contains "421 Legends Drive, Lewisville, TX". The sidebar on the left is identical to the top image. The pop-up information box on the right is also identical. The main map area shows a closer view of the houses, with a red location pin on "421 Legends Dr". The bottom status bar indicates a 100% zoom level, a camera height of 196 m, and a date of 11/1/2023.

Windows taskbar showing the search bar with "Type here to search" and several application icons including Chrome, File Explorer, and Amazon. The system tray on the right shows the date and time as 9:02 PM on 6/6/2024.

Browser address bar showing the URL: "https://earth.google.com/web/search/421+Legends+Drive,+Lewisville,+TX@33.0451768,-96.9896725,153.99109169a,62.36208342d,35y,-139.93566842h,47.55891291t,0.00000002r/data=Co...".

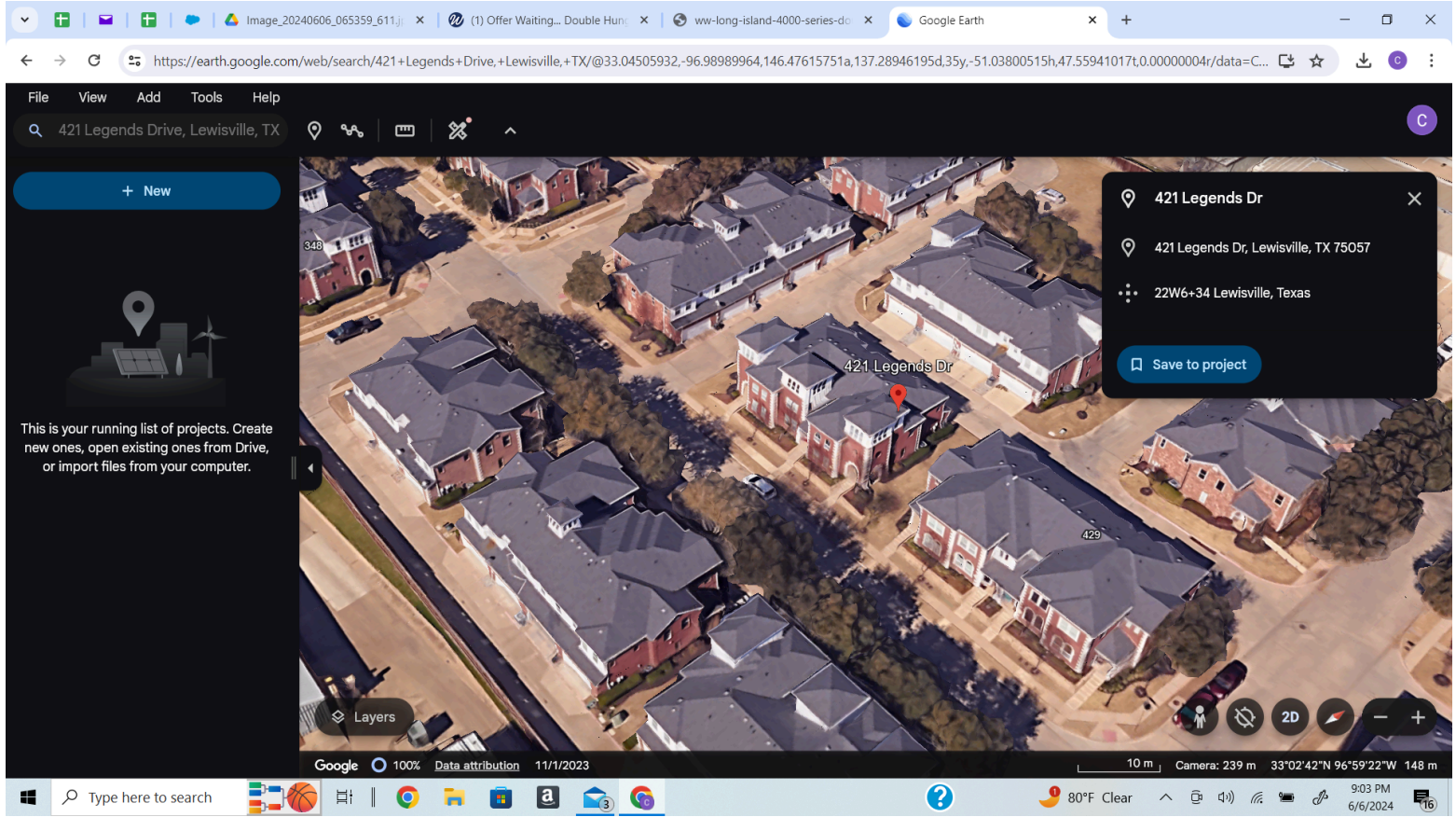

Please let me know if this will work.

Thanks,

Carolyn Goodwin

Owner

Zip Permits

Mobile: 972-670-6690

Email: zip.permits@yahoo.com

THIS DOCUMENT CREATES IMPORTANT LEGAL OBLIGATIONS THAT YOU SHOULD UNDERSTAND PRIOR TO SIGNING. YOU SHOULD READ IT THOROUGHLY AND IF YOU ARE UNCERTAIN OR HAVE QUESTIONS ABOUT YOUR RIGHTS, OBLIGATIONS OR RESPONSIBILITIES UNDER THIS CONTRACT, CONSULT AN ATTORNEY.



NewSouth Window of Tampa
 10741 Crossroads Commerce Blvd
 Tampa, FL 33610
 813-626-6000
 www.NewSouthWindow.com
 SCC131151763, CGC152780

Brian/Christina Potter/Bocelli
 421 Legends Dr
 Lewisville TX 75057

940-279-2580
 701cboc@proton.me
 314262

Date: 02/24/2024
 Rep: Matthew Forman

WHOLESALE & RETAIL WINDOW AND DOOR CONTRACT

Replacement Windows - Entry & Patio Doors - Impact Resistant Windows & Doors

Replacement Windows - Entry & Patio Doors - Impact Resistant Windows & Doors NewSouth Window Solutions agrees to measure, manufacture, furnish, install and service the following products for the amount STIPULATED BELOW. All NewSouth windows include an insulated glass unit with double pane, eVantage glass, argon gas, and 12 point fusion welded corners. NewSouth products are guaranteed to comply with code requirements for the specific location of the home. Thank you for your business.

The terms of the Lifetime Limited Transferable Warranty are expressly and fully incorporated into this contract, including but not limited to the limitation of remedies and exclusion of consequential damages contained therein

Secondary Initials

Are Co-Signer Initials Needed? NO

Window

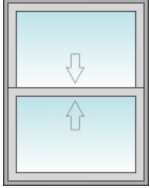

Window Icon
Window Style 1800 Double Hung
Location Living room
Height 72
Inside Color White
Glass Type eVantage
Oriel Yes

Window Number 1
Window Brand Non Impact
Width 36
Total UI 108
Outside Color White
Screen Type Half

Window

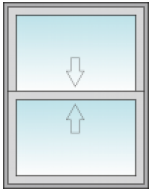

Window Icon
Window Style 1800 Double Hung
Location Living room
Height 72
Inside Color White
Glass Type eVantage
Oriel Yes

Window Number 2
Window Brand Non Impact
Width 36
Total UI 108
Outside Color White
Screen Type Half

Window

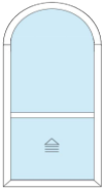

Window Icon
Window Style Single Hung Arch Top
Location Master bedroom
Height 72
Inside Color White
Glass Type eVantage

Window Number 7
Window Brand Non Impact
Width 36
Total UI 108
Outside Color White
Screen Type Half

This space intentionally left blank

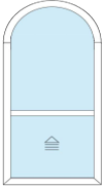
Window

Window Icon
Window Style Single Hung Arch Top
Location Master bedroom
Height 72
Inside Color White
Glass Type eVantage

Window Number 8
Window Brand Non Impact
Width 36
Total UI 108
Outside Color White
Screen Type Half

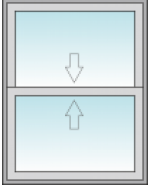
Window

Window Icon
Window Style 1800 Double Hung
Location Eric's bedroom
Height 60
Inside Color White
Glass Type eVantage

Window Number 9
Window Brand Non Impact
Width 36
Total UI 96
Outside Color White
Screen Type Half

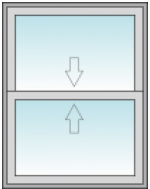
Window

Window Icon
Window Style 1800 Double Hung
Location Office
Height 60
Inside Color White
Glass Type eVantage

Window Number 10
Window Brand Non Impact
Width 24
Total UI 84
Outside Color White
Screen Type Half

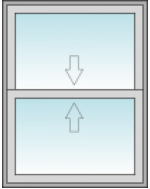
Window

Window Icon
Window Style 1800 Double Hung
Location Office
Height 60
Inside Color White
Glass Type eVantage

Window Number 11
Window Brand Non Impact
Width 24
Total UI 84
Outside Color White
Screen Type Half

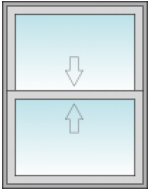
Window

Window Icon
Window Style 1800 Double Hung
Location Office
Height 60
Inside Color White
Glass Type eVantage

Window Number 12
Window Brand Non Impact
Width 36
Total UI 96
Outside Color White
Screen Type Half

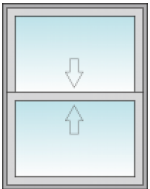
Window

Window Icon
Window Style 1800 Double Hung
Location Office
Height 60
Inside Color White
Glass Type eVantage

Window Number 13
Window Brand Non Impact
Width 36
Total UI 96
Outside Color White
Screen Type Half

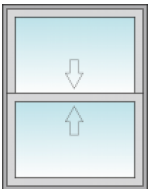
Window

Window Icon
Window Style 1800 Double Hung
Location Office bathroom
Height 36
Inside Color White
Glass Type eVantage

Window Number 14
Window Brand Non Impact
Width 24
Total UI 60
Outside Color White
Screen Type Half

Photos

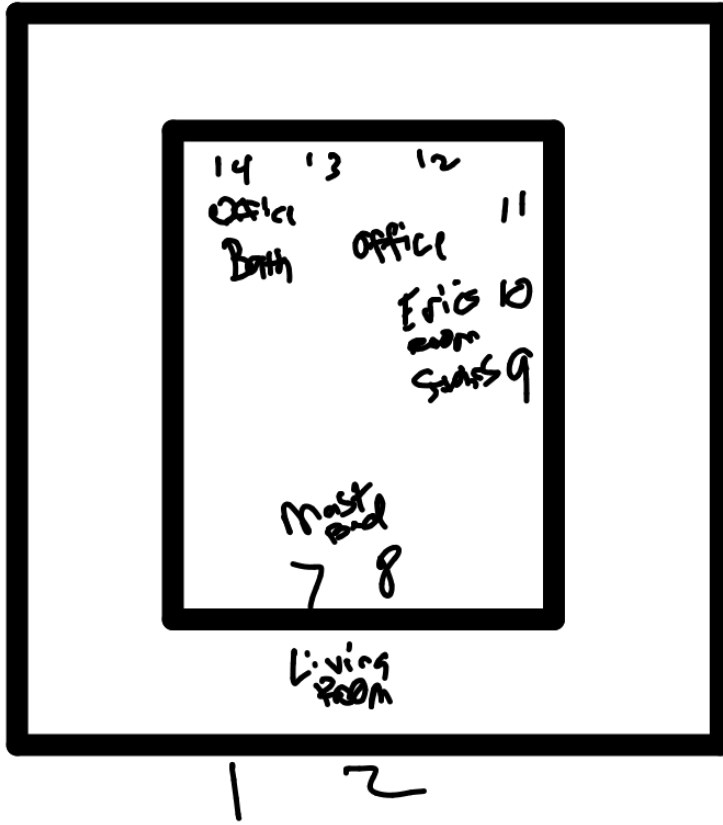

Contract Approval

To be considered valid, all contracts are to be reviewed and signed by an authorized NewSouth officer.

(Customer's Initials) BP CB

[Handwritten signature]

Brian/Christina Potter/Bocelli

02/24/2024

Date

[Handwritten signature]

Matthew Forman

02/24/2024

Date

This space intentionally left blank



National Fenestration
Rating Council®

CERTIFIED

NewSouth Window Solutions

Product: 8400DH

Vinyl - Double Glazing - Argon Fill - Low E

Vertical Slider Window

NSW - M - 14 - 00028 - 00002

ENERGY PERFORMANCE RATINGS

U-Factor (U.S./I-P)

0.30

Solar Heat Gain Coefficient

0.17

ADDITIONAL PERFORMANCE RATINGS

Visible Transmittance

0.40

Air Leakage (U.S./I-P)

≤ 0.3

Manufacturer stipulates that these ratings conform to applicable NFRC procedures for determining whole product performance. NFRC ratings are determined for a fixed set of environmental conditions and specific product size. NFRC does not recommend any product and does not warrant the suitability of any product for any specific use. Consult Manufacturer's literature for other product performance information.
www.nfrc.org



FL# 32346 1

DP: +50 / -50

AAMA/WDMA/CSA 101/I.S.2/A440-17

CLASS LC-PG50 1372 x 1900 (54 x 76) - H

REMOVE LABEL ONLY AFTER FINAL INSPECTION

ENERGY STAR™ Certified in Highlighted Regions

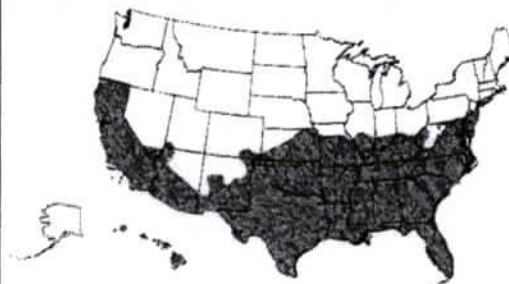

■ Certified



National Fenestration
Rating Council®

CERTIFIED

NewSouth Window Solutions

Product: 9400SH

Vinyl - Double Glazing - Argon Fill - Low E

Vertical Slider Window

NSW - M - 25 - 00060 - 00001

ENERGY PERFORMANCE RATINGS

U-Factor (U.S./I-P)

0.28

Solar Heat Gain Coefficient

0.20

ADDITIONAL PERFORMANCE RATINGS

Visible Transmittance

0.48

Air Leakage (U.S./I-P)

≤ 0.3

Manufacturer stipulates that these ratings conform to applicable NFRC procedures for determining whole product performance. NFRC ratings are determined for a fixed set of environmental conditions and specific product size. NFRC does not recommend any product and does not warrant the suitability of any product for any specific use. Consult Manufacturer's literature for other product performance information.
www.nfrc.org



FL# 16851 2

DP: +65 / -75

AAMA/WDMA/CSA101/I.S.2/A440 - 11/17

CLASS LC - PG65 1372x1930 (54x76) - H

REMOVE LABEL ONLY AFTER FINAL INSPECTION

ENERGY STAR® Certified in Highlighted Regions

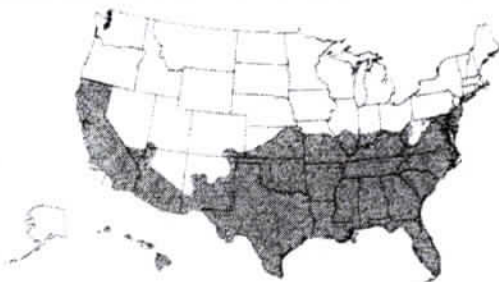

Certified



National Fenestration
Rating Council®

CERTIFIED

NewSouth Window Solutions

Product: 9400SH

Vinyl - Double Glazing - Argon Fill - Low E

Vertical Slider Window

NSW - M - 25 - 00060 - 00001

ENERGY PERFORMANCE RATINGS

U-Factor (U.S./I-P)

0.28

Solar Heat Gain Coefficient

0.20

ADDITIONAL PERFORMANCE RATINGS

Visible Transmittance

0.48

Air Leakage (U.S./I-P)

≤ 0.3

Manufacturer stipulates that these ratings conform to applicable NFRC procedures for determining whole product performance. NFRC ratings are determined for a fixed set of environmental conditions and specific product size. NFRC does not recommend any product and does not warrant the suitability of any product for any specific use. Consult Manufacturer's literature for other product performance information.
www.nfrc.org



FL# 16851 2

DP: +65 / -75

AAMA/WDMA/CSA101/I.S.2/A440 - 11/17

CLASS LC - PG65 1372x1930 (54x76) - H

REMOVE LABEL ONLY AFTER FINAL INSPECTION

ENERGY STAR® Certified in Highlighted Regions

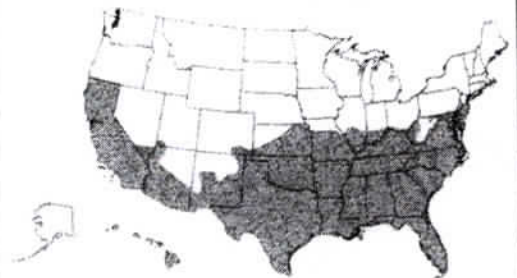

Certified

9000 SERIES

Blending impact resistance and Energy Star standards with a beautiful aesthetic

- 1 • 100% pure uPVC vinyl.**
Low maintenance; provides superior energy efficiency and durability.
- 2 • 12-point fusion welded corners.**
Watertight sash and frame.
- 3 • Multi-chambered 3 1/4" wide frame.**
Structurally sound and energy efficient.
- 4 • Glass Features**
 - A. Double pane & double strength glass that is stress tested.**
Ensures against seal failure due to heat.
 - B. Laminated glass with a 7/8" insulated unit.**
Patented eVantage 366 or 340 glass for maximum comfort.
- 5 • Aluminum reinforced sash.**
Optimal stability, structural integrity and security.
- 6 • Triple weather stripping.**
To prevent energy loss and to keep water out.
- 7 • Interlocking meeting rail that is twice as deep as industry standards.**
Prevents air & water infiltration, & resists forced entry attempts.
- 8 • Fiberglass mesh half-screen with extra deep 1/2" pocket.**
Extruded aluminum frame offers more stability for less screen shifting.
- 9 • Argon gas sealed glass unit.**
Aids in noise reduction and energy efficiency.
- 10 • XL Edge desiccant filled warm edge spacer system.**
Less heat transfer at the glass edge to help save energy.
- 11 • Recessed sloped external sill.**
Designed to shed water and keep your house dry during a storm.
- 12 • Built in, double strength integrated lift handle.**
Sturdy and long lasting, no snap-on pieces.
- 13 • State of the art self-locking system.**
Improved safety for your family.
- 14 • Recessed tilt latches.**
Allows bottom sash to tilt in with latch that is flush to the frame.



- Beveled Frame adds elegance
- Beautiful mill-work duplicated exterior frame

COLOR OPTIONS



SINGLE HUNG
Bottom Sash Tilts In



SLIDING WINDOW
2-Lite (XO, OX)
3-Lite (XOX)

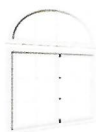

SHAPE WINDOW
Half-Round, Eyebrow,
Quarter-Round,
Trapezoid, and more



PICTURE WINDOW
Fixed Sash



CASEMENT/AWNING
Sash is Hinged and Opens

800-WINDOW-1 | NewSouthWindow.com



THE ULTIMATE TEXAS WINDOW. DESIGNED FOR THE LONE STAR STATE.

IMPACT RESISTANT HURRICANE WINDOWS

9000 **SERIES**

What makes NewSouth Window different?



Factory Direct

NewSouth provides you with a factory direct solution, which means we invest in our products with superior components. We have built a high-performance window to defend against the Lone Star State's weather; we call it the Ultimate Texas Window, you'll call it the last window you'll ever buy.

Lifetime Warranty

Here at NewSouth we manufacture, install, and guarantee our products and installation for life, giving you peace of mind. This is what we call single-source accountability which means you'll only ever need to make one call should an issue arise!

Energy Efficient

NewSouth Window Solutions Energy Star rated windows are made to better enhance the energy efficiency of your home. Our windows are manufactured with uPVC vinyl, Low-E glass and other cutting-edge technologies to keep the cool air in and the heat out. This will save energy and may even lead to a reduction in your monthly energy bill.



Impact Resistance

NewSouth is your solution when it comes to hurricane rated windows. Our impact-resistant windows are approved for use in the 175 MPH wind-borne debris region. Additional benefits to impact resistance are noise reduction and intruder resistance. Non-impact options are also available, please speak to your factory representative for more information.



800-WINDOW-1

NewSouthWindow.com

WE MANUFACTURE | WE INSTALL | WE GUARANTEE